

Installation Instructions

PAN WEEP

The **Polyguard Pan Weep (Pan Weep)** is a dimple board designed for draining sills and thresholds in flashed rough openings for non-flanged windows, doors, and fixtures. The weep openings also provide an area for venting the same area and thereby foster a dry surrounding environment through air movement.

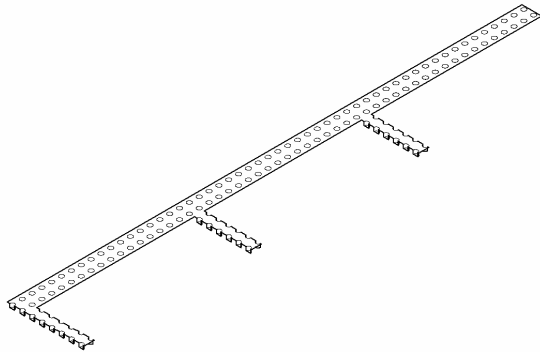

Isometric View

The continuous 3-foot body is 1-3/8-inches wide and the weep extensions are 3/4-inch wide and 4-inches long.

The weeps are spaced at 11-3/4-inches. This spacing reduces the likelihood of pooling of water at a low point across a flashing.

Installation Instructions

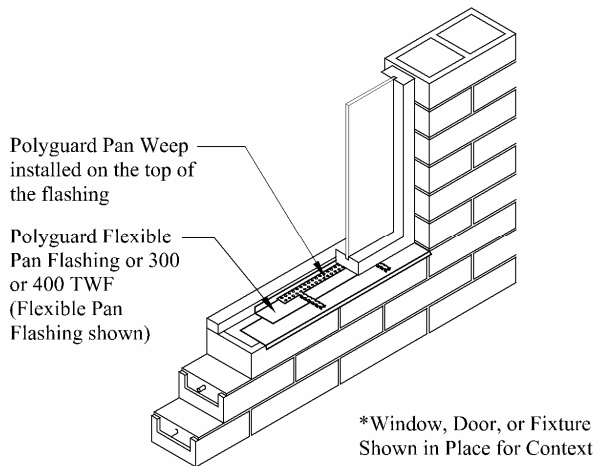

Place the **Pan Weep** dimple down over a flashed sill or threshold with the interior edge located to accommodate later placement of a backer rod and sealant. Omit placement of the **Pan Weep** under shims.

Install the window, door, or fixture, window shown.

Trim the Weep Extensions flush with the face of the sealant after the sealant has been tooled

Install Backer Rod and Sealant between the weep extensions in the space between the window, door or fixture frame and the drip edge

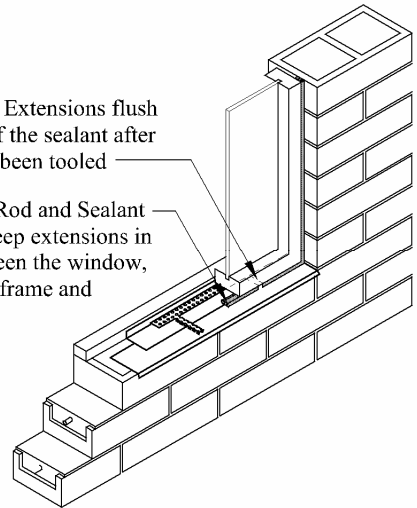

Install a backer rod and sealant between the weep extensions in the space between the window, door, or fixture frame and the drip edge.

Trim the weep extensions flush with the face of the sealant after the sealant has been tooled.

Polyguard Products, Inc.
PO Box 755
Ennis, TX 75120-0755
Phone: 214-515-5000
Fax: 972-875-9425
Tech Support: 513-404-0977
www.polyguardproducts.com
© Polyguard Products 2010

P.O. Box 755
Ennis, TX 75120
PH: (214) 515-5000
FX: (972) 875-9425

This information is based on our best knowledge, but POLYGUARD cannot guarantee the results to be obtained.