

**FLASHING INSTALLATION SEQUENCE FOR APPLIED EXTERIOR FINISHES AT ROOF TO WALL INTERSECTIONS:**

1. INSTALL THE SHINGLES TO THE INTERSECTION WITH THE FRONT WALL.
2. FABRICATE AND INSTALL A METAL APRON COUNTER FLASHING, WITH A LOWER FLANGE THAT EXTENDS ONTO THE FINISH ROOFING MATERIAL, AND A HEIGHT THAT WILL ENGAGE ¾-INCH OF THE COUNTER FLASHING EXTERNAL LEG AND ALLOW ROOM FOR VERTICAL MOVEMENT OF THE METAL FLASHING.
3. INSTALL ROOF SHINGLES AND STEP FLASHING ALONG THE SIDEWALL.
4. FABRICATE AND INSTALL A METAL APRON FLASHING WITH A HEIGHT THAT WILL ENGAGE ¾-INCH OF THE COUNTER FLASHING EXTERNAL LEG AND ALLOW ROOM FOR VERTICAL MOVEMENT OF THE METAL FLASHING.
5. INSTALL ROOF SHINGLES AND STEP FLASHING ALONG THE BACK / UPPER WALL.
6. FABRICATE AND INSTALL METAL APRON FLASHING WITH A HEIGHT THAT WILL ENGAGE ¾-INCH OF THE COUNTER FLASHING EXTERNAL LEG AND ALLOW ROOM FOR VERTICAL MOVEMENT OF THE METAL FLASHING.

**NOTE:** FREE THE SURFACES THAT WILL RECEIVE THE FLASHING FROM IRREGULARITIES THAT WOULD INTERFERE WITH A FLAT INTERFACE WITH THE FLASHING, OR POSE A FLASHING PUNCTURE HAZARD. APPLY A COATING OF 650LT, CALIFORNIA SEALANT, GREEN CALIFORNIA SEALANT OR SHUR-TAC WATER-BASED LIQUID ADHESIVE TO CLEAN AND DRY SURFACES THAT WILL BE RECEIVING THE FLASHINGS. BASE SELECTION OF LIQUID ADHESIVE ON SUBSTRATE COMPATIBILITY AND VOC REQUIREMENTS. REFER TO POLYGUARDS PUBLICATION "PRINCIPLES OF WATERPROOFING ABOVE GRADE EXTERIOR WALL ASSEMBLIES" FOR STEP BY STEP INSTALLATION INSTRUCTIONS.

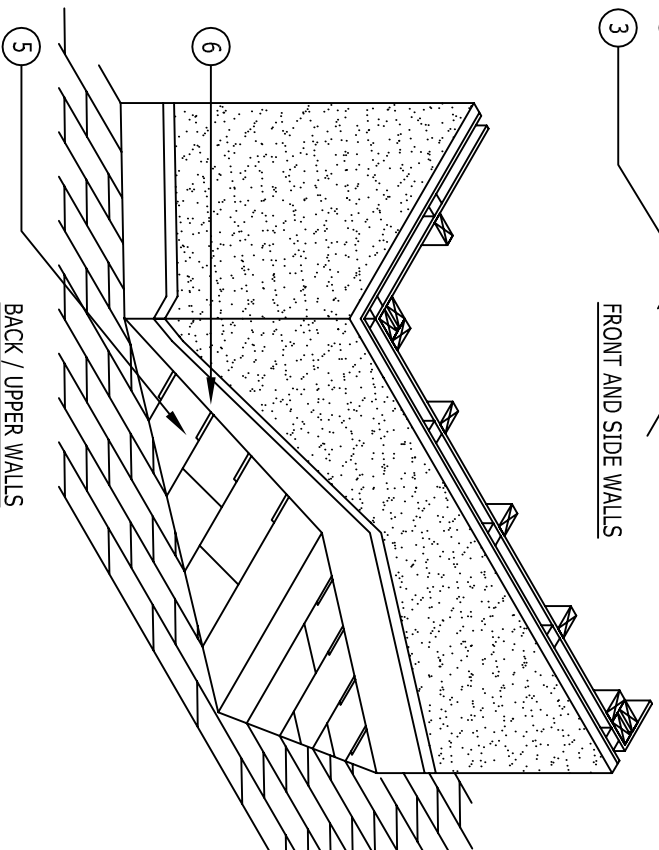

TWFF20.3

TWF APPLIED EXTERIOR FINISH AT WALL TO ROOF INTERSECTION (3 OF 3 FIGURES)

© POLYGUARD PRODUCTS, INC. 2010

\*\*MATERIALS SEPARATED FOR CLARITY\*\* NTS