

SELF-ADHERING FLASHING AND STAINLESS STEEL DRIP EDGE

- **Preformed Stainless Steel Drip Edges** can be used in conjunction with **Polyguard Thru Wall Flashings**. The **Drip Edge** is 28 gauge (15 mils thick), 1 5/8" inches wide with a 3/8" inch bend at one end made of Type 304 grade, dull finish stainless steel which complies to ASTM A-167. They are supplied in 8 foot pieces.
- The **Drip Edge** is set along the edge of the shelf angle. Apply the **Thru Wall Flashing** to **Drip Edge** leaving approximately 1 inch from drip edge.

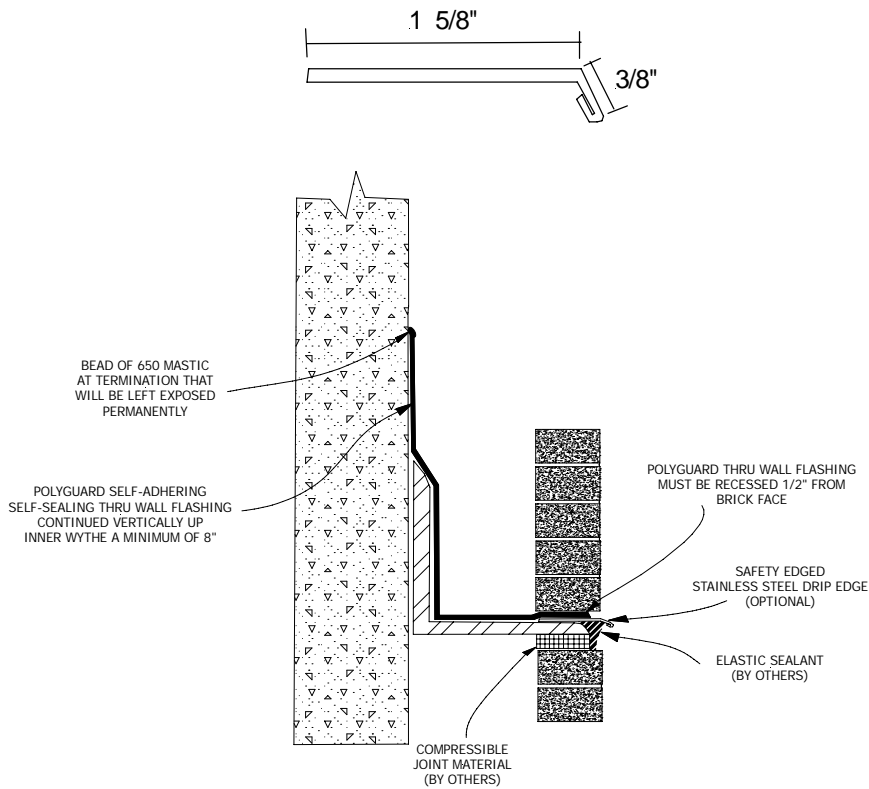

x:lit/masonry/dripedge.doc R. 1-24-06



This information is based on our best knowledge, but POLYGUARD cannot guarantee the results to be obtained.

POLYGUARD PRODUCTS INC • ENNIS, TEXAS 75120-0755
PH: 800-541-4994 • 972-875-8421 • FAX: 972-875-9425
Web Site: www.polyguardproducts.com



As of 9/1/2003 Polyguard Products' quality system has been certified to American, Dutch and German quality system requirements:

- AMERICAN NATIONAL STANDARDS INSTITUTE
- DUTCH COUNCIL FOR CERTIFICATION
- DEUTSCHER AKKREDITIERUNGS RAT