

12" STRIP OF TERM FLASHING BARRIER APPLIED WITH ASPHALT SIDE UP TO RECEIVE TERM UNDERSLAB WATERPROOFING / TERMITE BARRIER BACKING, EXTEND FLASHING A MINIMUM 4" BEYOND TOP EDGE OF TERM UNDERSLAB WATERPROOFING / TERMITE BARRIER. ROLL FLAT WITH ROLLER.

TERM UNDERSLAB WATERPROOFING / TERMITE BARRIER APPLIED AND OVERLAPPED WITH 4" EXPOSED ASPHALT EDGE

4" EXPOSED ASPHALT FOR OVERLAP AT SEAM

TERM UNDERSLAB FABRIC BARRIER TAPE REQUIRED OVER PRIMED TERM UNDERSLAB WATERPROOFING / TERMITE BARRIER SEAM (FULL LENGTH NOT SHOWN FOR CLARITY)

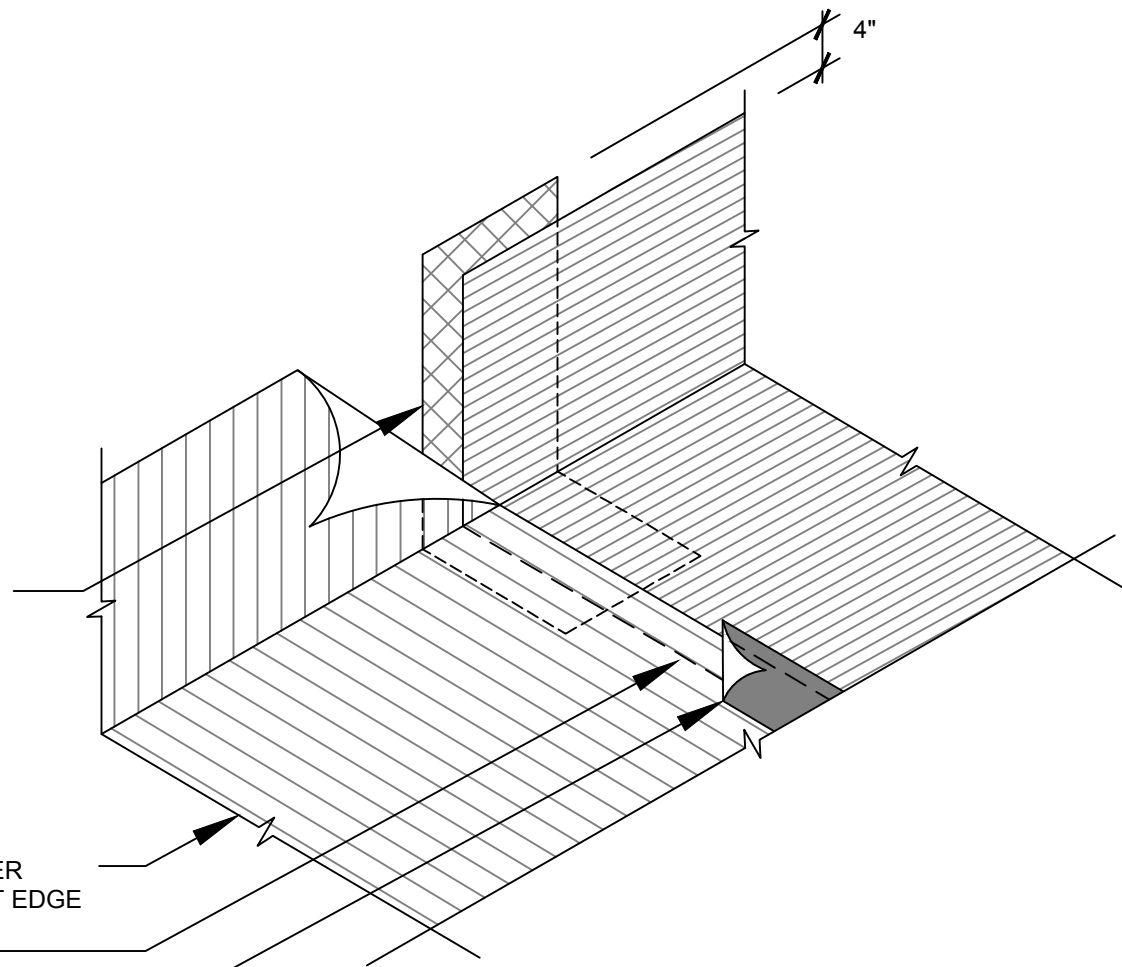

## SECTION @ HORIZONTAL-TO-VERTICAL TERM UNDERSLAB WATERPROOFING / TERMITE BARRIER SEAM

TU15

© POLYGUARD PRODUCTS, INC.

**Polyguard**<sup>®</sup>  
Innovation based. Employee owned. Expect more.  
P.O. Box 755 - Ennis, TX 75120  
Phone: 214-515-5000 Fax: 972-875-9425  
Web Site - [www.polyguardbarriers.com](http://www.polyguardbarriers.com)



The information provided is based on data and knowledge considered to be true and accurate and is offered for the users' consideration, investigation, and verification; but we do not warrant the results to be achieved. Please read all data sheets, statements, suggestions, or recommendations in conjunction with our conditions of sale, which apply to all goods supplied by us.

DRAWING SCALE:	NOT TO SCALE
EFFECTIVE DATE:	03/01/2018
SUPERCEDES:	05/18/2017